

5. Rear Gate and Glass

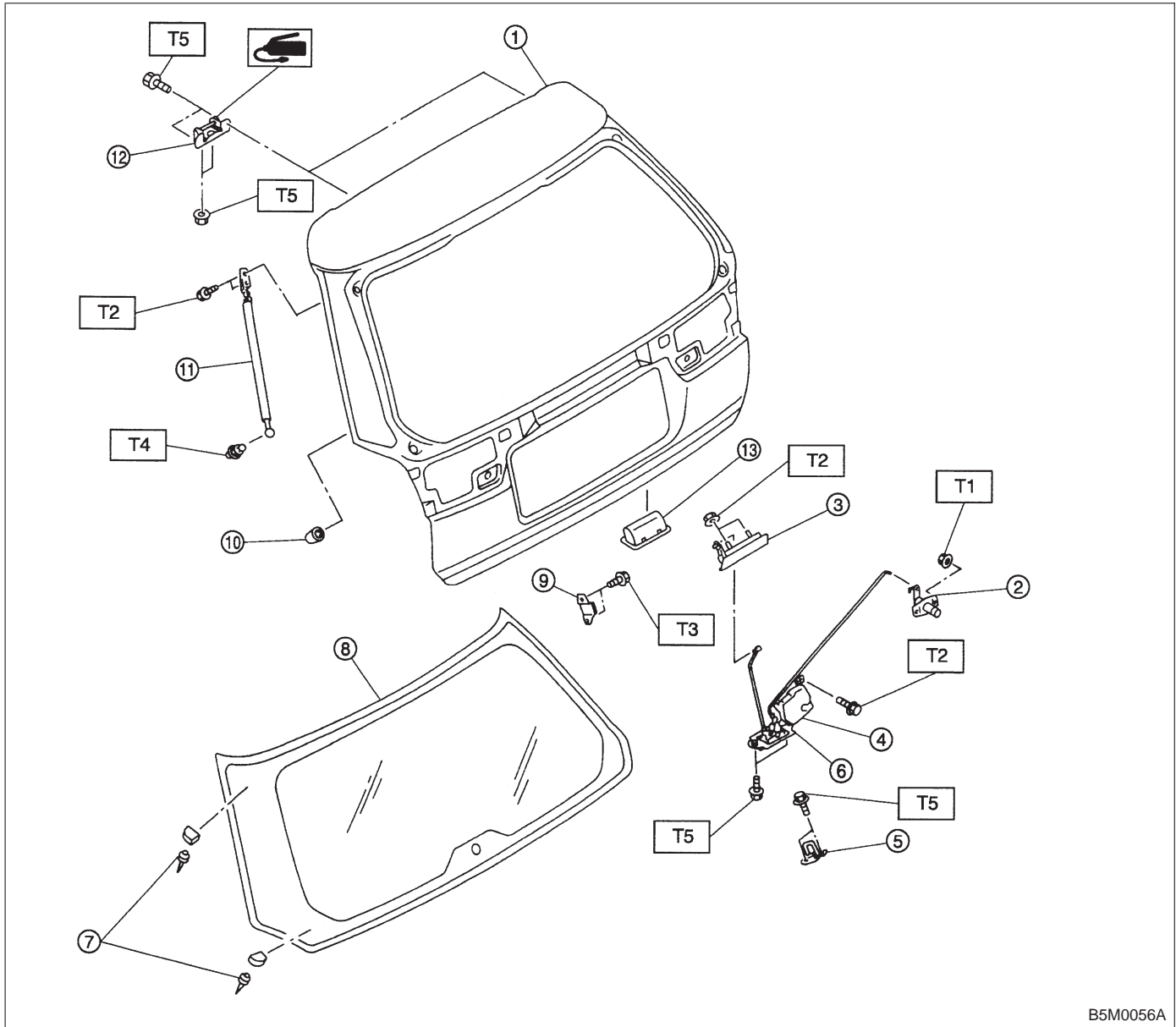

B5M0056A

- |                      |                    |
|----------------------|--------------------|
| ① Rear gate          | ⑧ Glass            |
| ② Key cylinder       | ⑨ Buffer           |
| ③ Outer handle       | ⑩ Stopper          |
| ④ Door lock actuator | ⑪ Gas stay         |
| ⑤ Striker            | ⑫ Hinge            |
| ⑥ Latch              | ⑬ Rear gate handle |
| ⑦ Glass pin          |                    |

**Tightening torque: N·m (kg·m, ft·lb)**

T1: 4.4±1.5 (0.45±0.15, 3.3±1.1)

T2: 7.4±2.0 (0.75±0.2, 5.4±1.4)

T3: 13±3 (1.3±0.3, 9.4±2.2)

T4: 14±4 (1.4±0.4, 10.1±2.9)

T5: 25±5 (2.5±0.5, 18.1±3.6)