

## 7. High Clutch and Planetary Gear

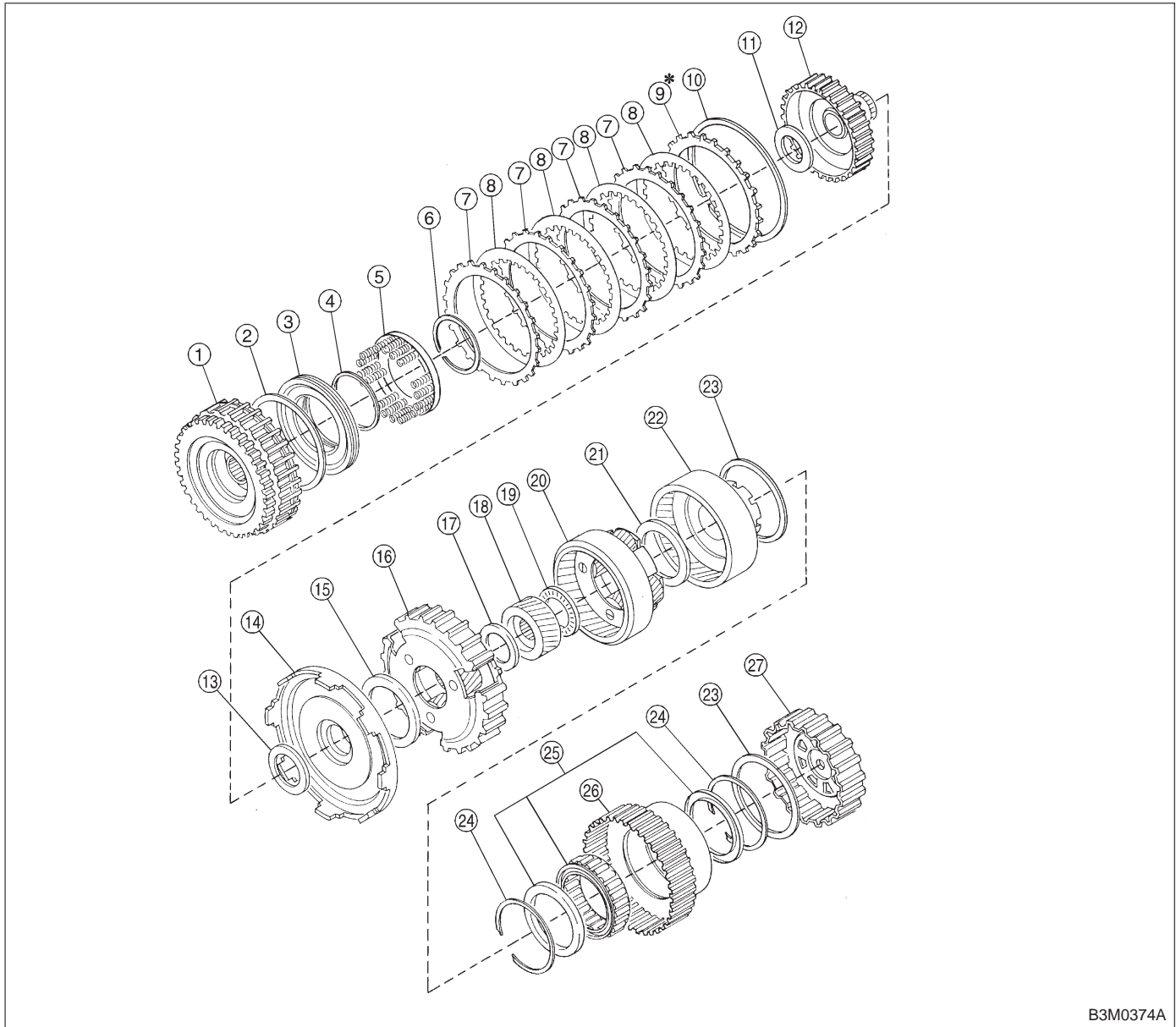

B3M0374A

- |                         |                                   |
|-------------------------|-----------------------------------|
| ① High clutch drum      | ⑮ Thrust needle bearing           |
| ② Lathe cut seal ring   | ⑯ Front planetary carrier         |
| ③ Piston                | ⑰ Thrust needle bearing           |
| ④ Lathe cut seal ring   | ⑱ Rear sun gear                   |
| ⑤ Spring retainer       | ⑲ Thrust needle bearing           |
| ⑥ Snap ring             | ⑳ Rear planetary carrier          |
| ⑦ Driven plate          | ㉑ Thrust needle bearing           |
| ⑧ Drive plate           | ㉒ Rear internal gear              |
| ⑨ Retaining plate       | ㉓ Thrust washer                   |
| ⑩ Snap ring             | ㉔ Snap ring                       |
| ⑪ Thrust needle bearing | ㉕ One-way clutch (3-4)            |
| ⑫ High clutch hub       | ㉖ One-way clutch outer race (3-4) |
| ⑬ Thrust needle bearing | ㉗ Overrunning clutch hub          |
| ⑭ Front sun gear        |                                   |