

### 5. Transmission Case, Transmission Cover and Control Device

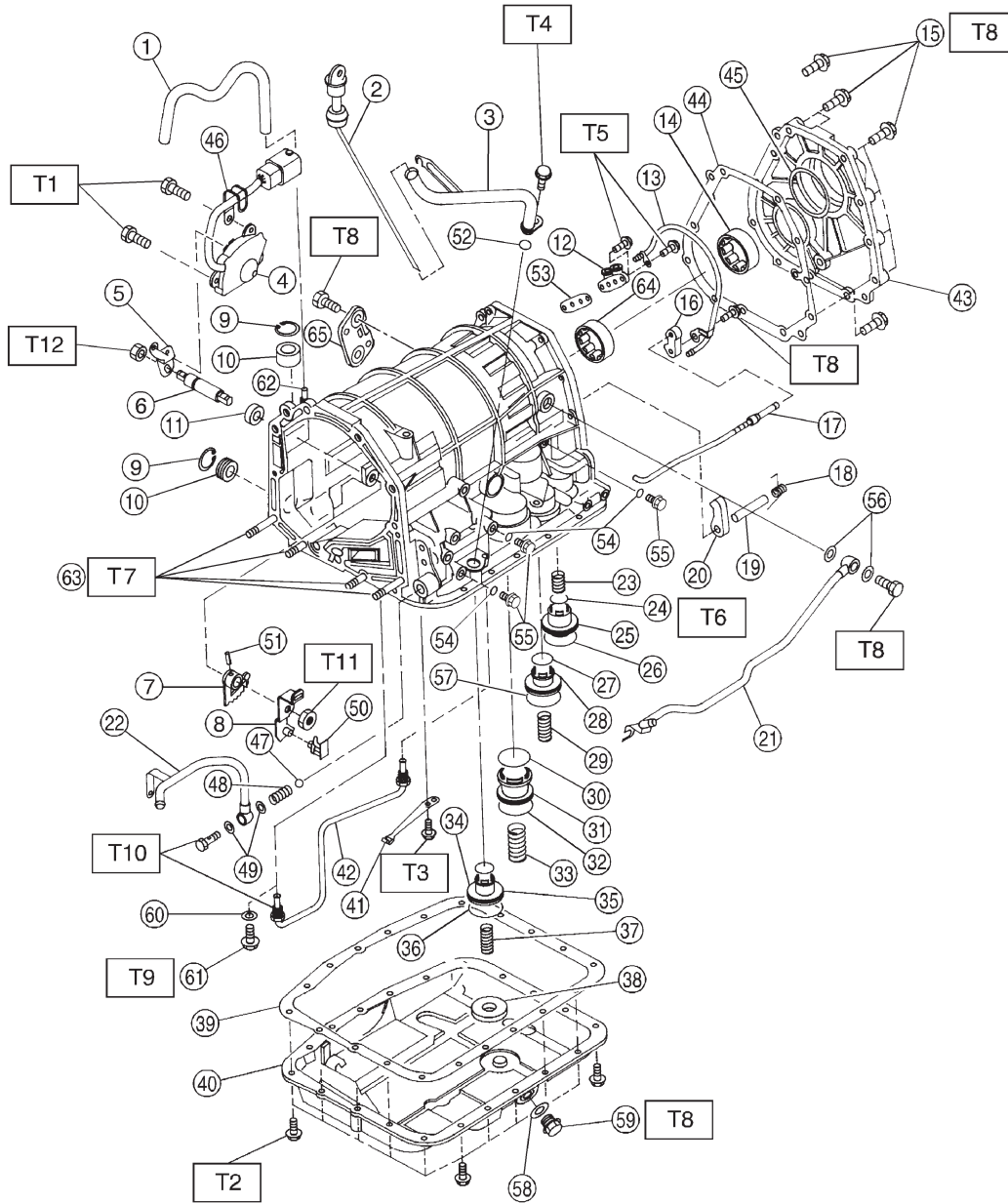

B3M0349A

- ① Air breather hose
- ② Oil level gauge
- ③ Oil charger pipe
- ④ Inhibitor switch
- ⑤ Range select lever
- ⑥ Manual shaft
- ⑦ Manual plate
- ⑧ Manual lever
- ⑨ Snap ring
- ⑩ Plug
- ⑪ Oil seal
- ⑫ Relief valve
- ⑬ Pipe
- ⑭ Roller bearing
- ⑮ Flange bolt
- ⑯ Parking support
- ⑰ Parking rod
- ⑱ Return spring
- ⑲ Shaft
- ⑳ Parking pawl
- ㉑ Inlet pipe
- ㉒ Outlet pipe
- ㉓ Spring
- ㉔ O-ring
- ㉕ Accumulator piston (N-D)
- ㉖ O-ring
- ㉗ O-ring
- ㉘ Accumulator piston (2-3)
- ㉙ Spring
- ㉚ O-ring
- ㉛ Accumulator piston (1-2)
- ㉜ O-ring
- ㉝ Spring
- ㉞ O-ring
- ㉟ Accumulator piston (3-4)
- ㊱ O-ring
- ㊲ Spring
- ㊳ Magnet
- ㊴ Gasket
- ㊵ Oil pan

- ㊶ Detention spring
- ㊷ Pipe (AWD model)
- ㊸ Transmission cover (FWD model)
- ㊹ Gasket
- ㊺ Shim
- ㊻ Clip
- ㊼ Ball
- ㊽ Spring
- ㊾ Gasket
- ㊿ Stopper
- ① Spring pin
- ② Gasket
- ③ Gasket
- ④ O-ring
- ⑤ Test plug
- ⑥ Gasket
- ⑦ O-ring
- ⑧ Gasket
- ⑨ Drain plug
- ⑩ Gasket (FWD model)
- ⑪ Plug (FWD model)
- ⑫ Nipple
- ⑬ Stud bolt
- ⑭ Ball bearing
- ⑮ Plate ASSY

---

**Tightening torque: N·m (kg-m, ft-lb)**

- T1: 3.4±0.5 (0.35±0.05, 2.5±0.4)**
  - T2: 4.9±0.5 (0.50±0.05, 3.6±0.4)**
  - T3: 5.9±1.0 (0.60±0.10, 4.3±0.7)**
  - T4: 6.4±0.5 (0.65±0.05, 4.7±0.4)**
  - T5: 7.8±1.0 (0.80±0.10, 5.8±0.7)**
  - T6: 12.7±1.0 (1.30±0.10, 9.4±0.7)**
  - T7: 17.7±2.9 (1.80±0.30, 13.0±2.2)**
  - T8: 24.5±2.0 (2.50±0.20, 18.1±1.4)**
  - T9: 30.9±3.4 (3.15±0.35, 22.8±2.5)**
  - T10: 34.3±2.9 (3.50±0.30, 25.3±2.2)**
  - T11: 47.1±2.0 (4.80±0.20, 34.7±1.4)**
  - T12: 47.1±4.9 (4.80±0.50, 34.7±3.6)**
-