

8. Forward Clutch and Low & Reverse Brake

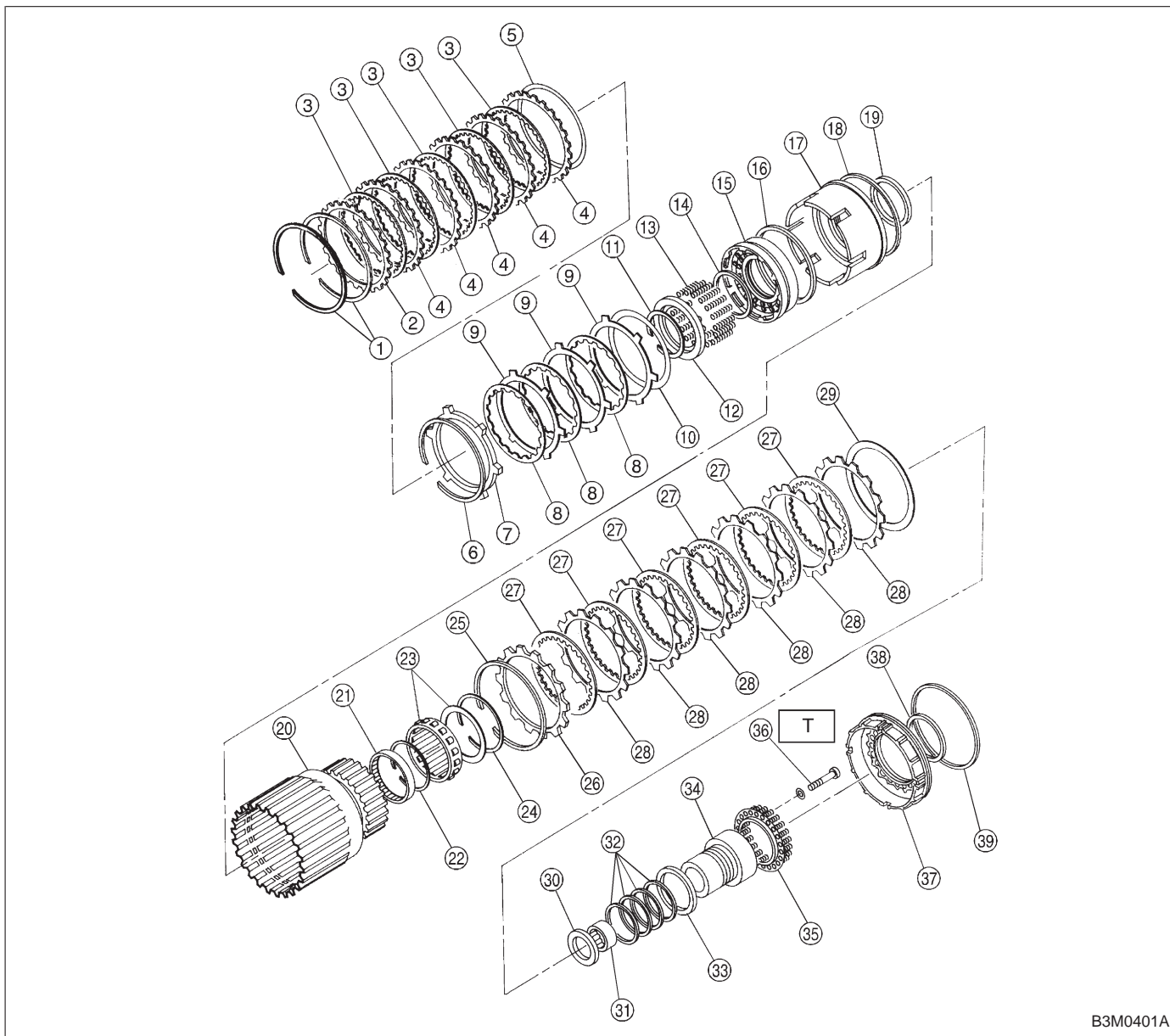

B3M0401A

- ① Snap ring
- ② Retaining plate
- ③ Drive plate (5)
- ④ Driven plate (5)
- ⑤ Dish plate
- ⑥ Snap ring
- ⑦ Retaining plate
- ⑧ Drive plate
- ⑨ Driven plate
- ⑩ Dish plate
- ⑪ Snap ring
- ⑫ Spring retainer
- ⑬ Spring
- ⑭ Lathe cut seal ring
- ⑮ Overrunning piston

- ⑯ Lathe cut seal ring
- ⑰ Forward piston
- ⑱ Lip seal
- ⑲ Lathe cut seal ring
- ⑳ Forward clutch drum
- ㉑ Needle bearing
- ㉒ Snap ring
- ㉓ One-way clutch (1-2)
- ㉔ Snap ring
- ㉕ Snap ring
- ㉖ Retaining plate
- ㉗ Drive plate (6)
- ㉘ Driven plate (6)
- ㉙ Dish plate
- ㉚ Thrust needle bearing

- ㉛ Needle bearing
- ㉜ Seal ring
- ㉝ Thrust washer
- ㉞ One-way clutch inner race (1-2)
- ㉟ Spring retainer
- ⓪ Socket bolt
- ㊱ Low & reverse piston
- ㊲ Lathe cut seal ring
- ㊳ Lathe cut seal ring

Tightening torque: N·m (kg·m, ft·lb)
T: 25±2 (2.5±0.2, 18.1±1.4)