

## 5. Spark Plug Cord

### A: INSPECTION

Check for:

- 1) Damage to cords, deformation, burning or rust formation of terminals
- 2) Resistance values of cords

**Resistance value:**

**5.12 — 12.34 kΩ**

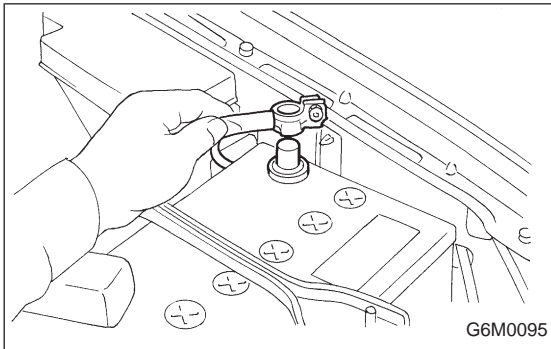

## 6. Ignitor

### A: REMOVAL AND INSTALLATION

- 1) Disconnect battery ground cable.
- 2) Disconnect connector from ignitor.
- 3) Remove screws which hold ignitor onto body.
- 4) Installation is in the reverse order of removal.

