

7. High Clutch and Planetary Gear

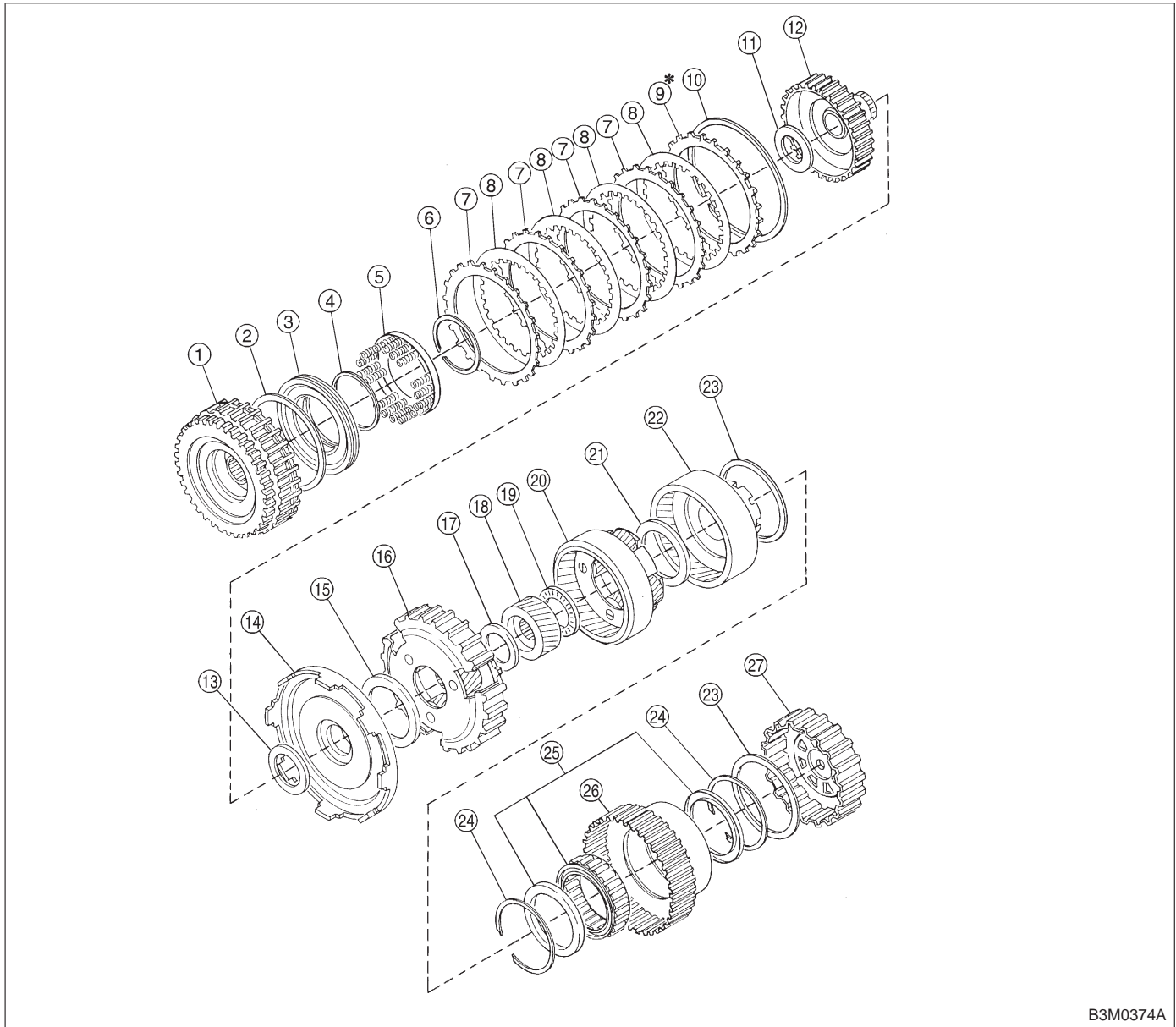

B3M0374A

- | | |
|-------------------------|-----------------------------------|
| ① High clutch drum | ⑮ Thrust needle bearing |
| ② Lathe cut seal ring | ⑯ Front planetary carrier |
| ③ Piston | ⑰ Thrust needle bearing |
| ④ Lathe cut seal ring | ⑱ Rear sun gear |
| ⑤ Spring retainer | ⑲ Thrust needle bearing |
| ⑥ Snap ring | ⑳ Rear planetary carrier |
| ⑦ Driven plate | ㉑ Thrust needle bearing |
| ⑧ Drive plate | ㉒ Rear internal gear |
| ⑨ Retaining plate | ㉓ Thrust washer |
| ⑩ Snap ring | ㉔ Snap ring |
| ⑪ Thrust needle bearing | ㉕ One-way clutch (3-4) |
| ⑫ High clutch hub | ㉖ One-way clutch outer race (3-4) |
| ⑬ Thrust needle bearing | ㉗ Overrunning clutch hub |
| ⑭ Front sun gear | |