

8. Forward Clutch and Low & Reverse Brake

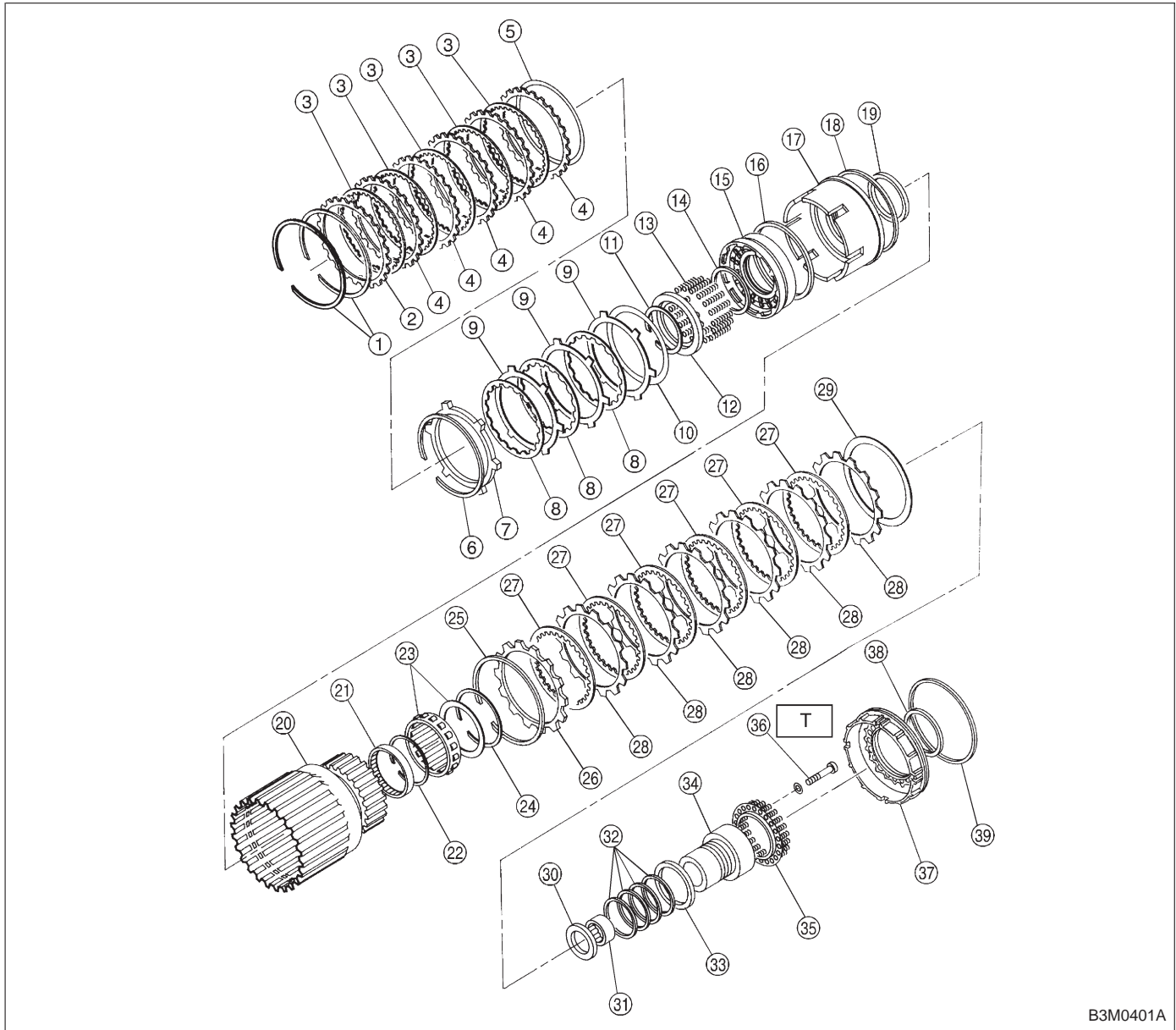

B3M0401A

- | | | |
|--------------------|-----------------------|-----------------------------------|
| ① Snap ring | ⑩ Dish plate | ⑲ Lathe cut seal ring |
| ② Retaining plate | ⑪ Snap ring | ⑳ Forward clutch drum |
| ③ Drive plate (5) | ⑫ Spring retainer | ㉑ Needle bearing |
| ④ Driven plate (5) | ⑬ Spring | ㉒ Snap ring |
| ⑤ Dish plate | ⑭ Lathe cut seal ring | ㉓ One-way clutch (1-2) |
| ⑥ Snap ring | ⑮ Overrunning piston | ㉔ Snap ring |
| ⑦ Retaining plate | | ㉕ Snap ring |
| ⑧ Drive plate | | ㉖ Retaining plate |
| ⑨ Driven plate | | ㉗ Drive plate (6) |
| | | ㉘ Driven plate (6) |
| | | ㉙ Dish plate |
| | | ⑳ Thrust needle bearing |
| | | ㉚ Needle bearing |
| | | ㉛ Seal ring |
| | | ㉜ Thrust washer |
| | | ㉝ One-way clutch inner race (1-2) |
| | | ㉞ Spring retainer |
| | | ㉟ Socket bolt |
| | | ㊱ Low & reverse piston |
| | | ㊲ Lathe cut seal ring |
| | | ㊳ Lathe cut seal ring |

Tightening torque: N·m (kg·m, ft·lb)
T: 25±2 (2.5±0.2, 18.1±1.4)