

1. Supplemental Restraint System "Airbag"

1. Supplemental Restraint System "Airbag"

Airbag system wiring harness is routed on and along body panels.

CAUTION:

- All Airbag system wiring harness and connectors are colored yellow. Do not use electrical test equipment on these circuits.
- Be careful not to damage Airbag system wiring harness when repairing the body panel.

A: ENGINE COMPARTMENT AND ROOM

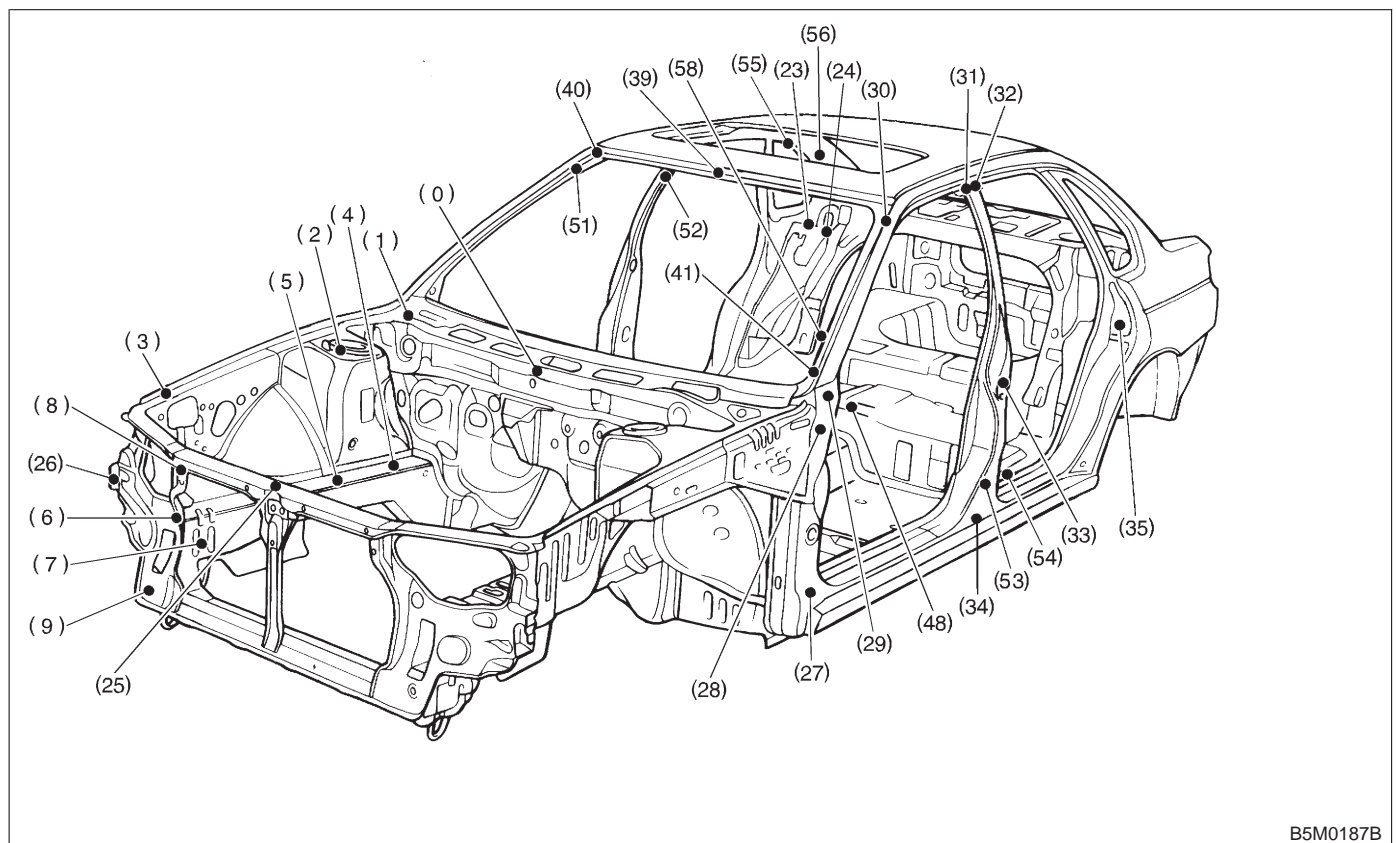

- | | | |
|---|---|---|
| (0) Cowl panel weather attaching hole 6 mm (0.24 in) dia. | (7) Side frame of front side frame 12 mm (0.47 in) dia. | (27) Front fender attaching hole at front pillar lower portion M6 |
| (1) Hood hinge front attaching hole M8 | (8) Headlight attaching hole at radiator side panel 6.2 × 9 mm (0.244 × 0.35 in) dia. | (28) Hinge middle hole at front pillar center 10 mm (0.39 in) dia. |
| (2) Strut mount attaching hole (Front center) 9.5 mm (0.374 in) dia. | (9) Radiator panel side (LWR) gauge hole 23 mm (0.91 in) dia. | (29) Front fender attaching hole at front pillar center portion M6 |
| (3) Front fender attaching hole (Tip) M6 | (23) Rear strut mount attaching hole (Side) 10 mm (0.39 in) dia. | (30) Retainer attaching square hole at front pillar 7 × 7 mm (0.28 × 0.28 in) |
| (4) Rear upper surface of front side frame 12 mm (0.47 in) dia. | (24) Rear strut mount attaching hole (Center) 12 mm (0.47 in) (0.244 × 0.35 in) dia. | (31) Retainer attaching hole at center pillar (Front) 3.5 mm (0.138 in) dia. |
| (5) Middle upper surface of front side frame 20 mm (0.79 in) dia. | (25) Radiator panel (UPR) middle hole 6 mm (0.24 in) dia. | (32) Retainer attaching hole at center pillar (Rear) 3.5 mm (0.138 in) dia. |
| (6) Front side frame front upper surface 14 × 16 mm (0.55 × 0.63 in) dia. oblong hole | (26) Front fender attaching hole at radiator panel side M6 | |

2. Body Datum Points

Various master repair locations are established as datum points used during body repairs. In addition, guide holes, locators and indents are provided to facilitate panel replacement and achieve alignment accuracy.

NOTE:

Left and right datum points are all symmetrical to each other.