

2) Connect evaporation hose to pipe by approx. 15 mm (0.59 in) from hose end.

$L = 15 - 20 \text{ mm (0.59 - 0.79 in)}$

CAUTION:

Be sure to inspect hoses and their connections for any leakage of fuel.

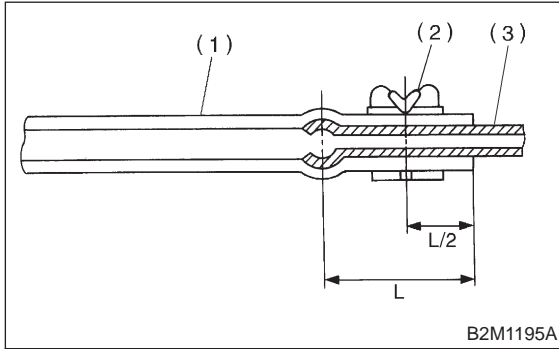

- (1) Hose
- (2) Clip
- (3) Pipe

8. Roll Over Valve

A: REMOVAL AND INSTALLATION

- 1) Lift up the vehicle.
- 2) Remove roll over valve with bracket.

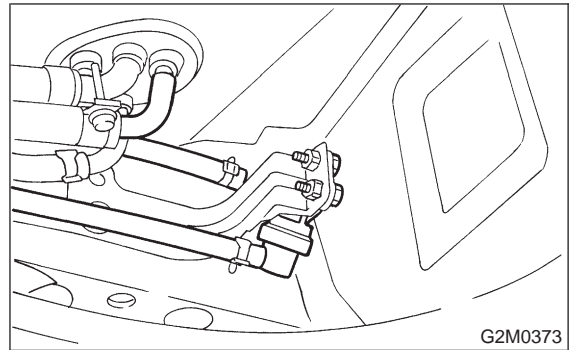

- 3) Disconnect hoses from roll over valve, and remove it from bracket.
- 4) Installation is in the reverse order of removal.

CAUTION:

- Do not install top side of valve down.
- Before installing bracket on body, securely fit concave part of bracket to hole in body.

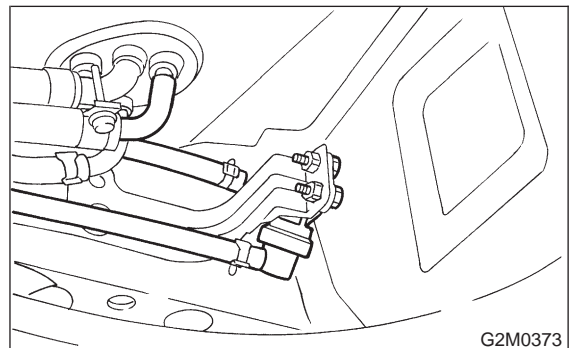

B: INSPECTION

- 1) Connect hoses to roll over valve as shown in Figure.

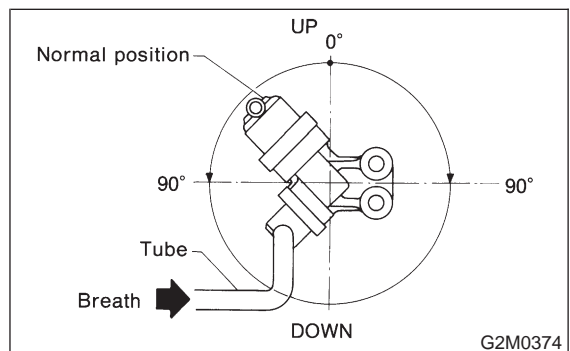

- 2) While blowing through open end of hose, tilt valve at least 90° left and right from normal position.

3) Ensure that there is no air flow when hose is tilted greater than 90°.

9. Fuel Sub Meter Unit (AWD model only)

A: REMOVAL AND INSTALLATION

1) Disconnect battery ground cable.

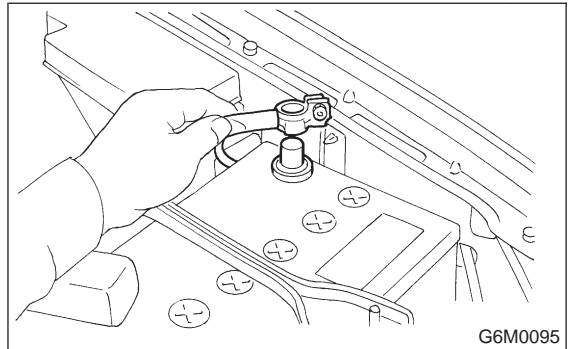

2) Remove rear seat.

3) Remove service hole cover.

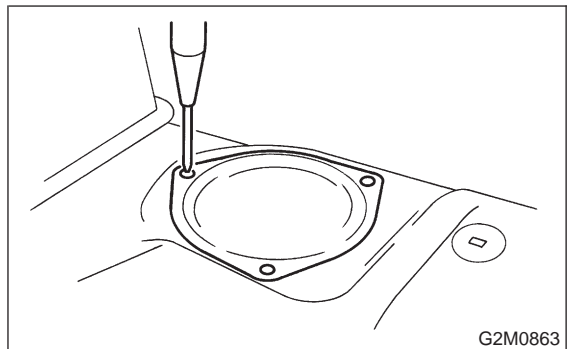

4) Disconnect connector from fuel sub meter, and disconnect jet pump hose.

