

3) Ensure that there is no air flow when hose is tilted greater than 90°.

9. Fuel Sub Meter Unit (AWD model only)

A: REMOVAL AND INSTALLATION

1) Disconnect battery ground cable.

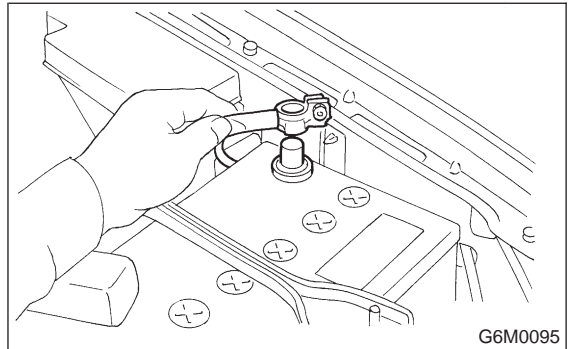

2) Remove rear seat.

3) Remove service hole cover.

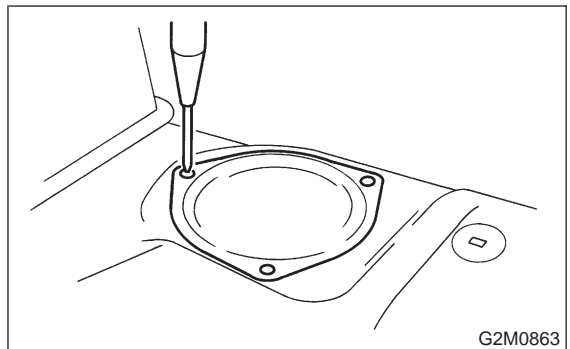

4) Disconnect connector from fuel sub meter, and disconnect jet pump hose.

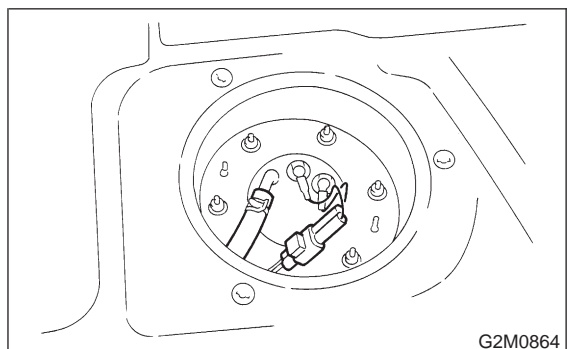

5) Remove fuel sub meter unit.

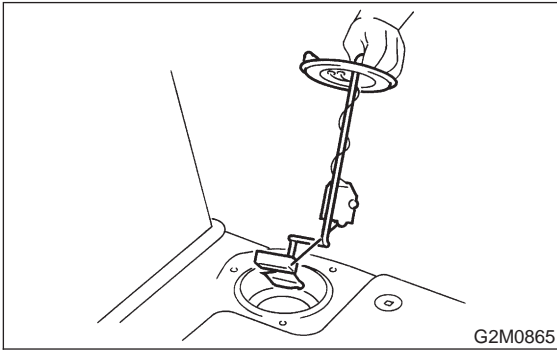

6) Installation is in the reverse order of removal.

Tightening torque:

T: 4.4 ± 1.5 N-m (0.45 ± 0.15 kg-m, 3.3 ± 1.1 ft-lb)

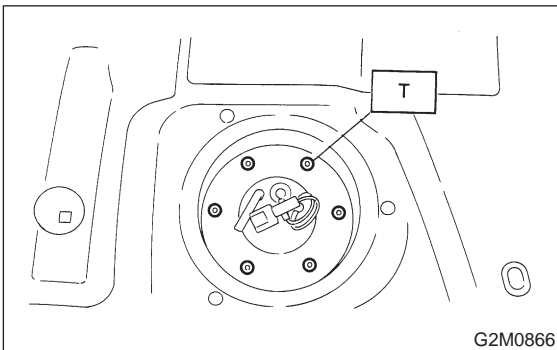

10. Fuel Cut Valve (AWD model only)

A: REMOVAL AND INSTALLATION

1) Remove fuel tank. <Ref. to 2-8 [W2A0].>

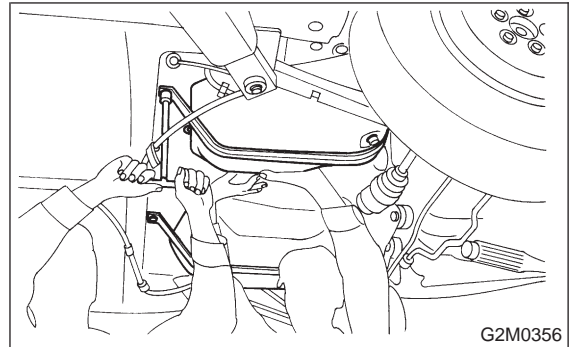

2) Disconnect evaporation hose from fuel cut valve.

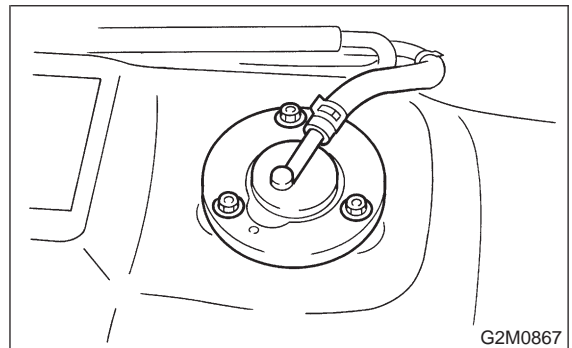

3) Remove fuel cut valve.

4) Installation is in the reverse order of removal.

Tightening torque:

4.4 ± 1.5 N-m (0.45 ± 0.15 kg-m, 3.3 ± 1.1 ft-lb)

