

3. Main Shaft Assembly

A: 2200 cc MODEL

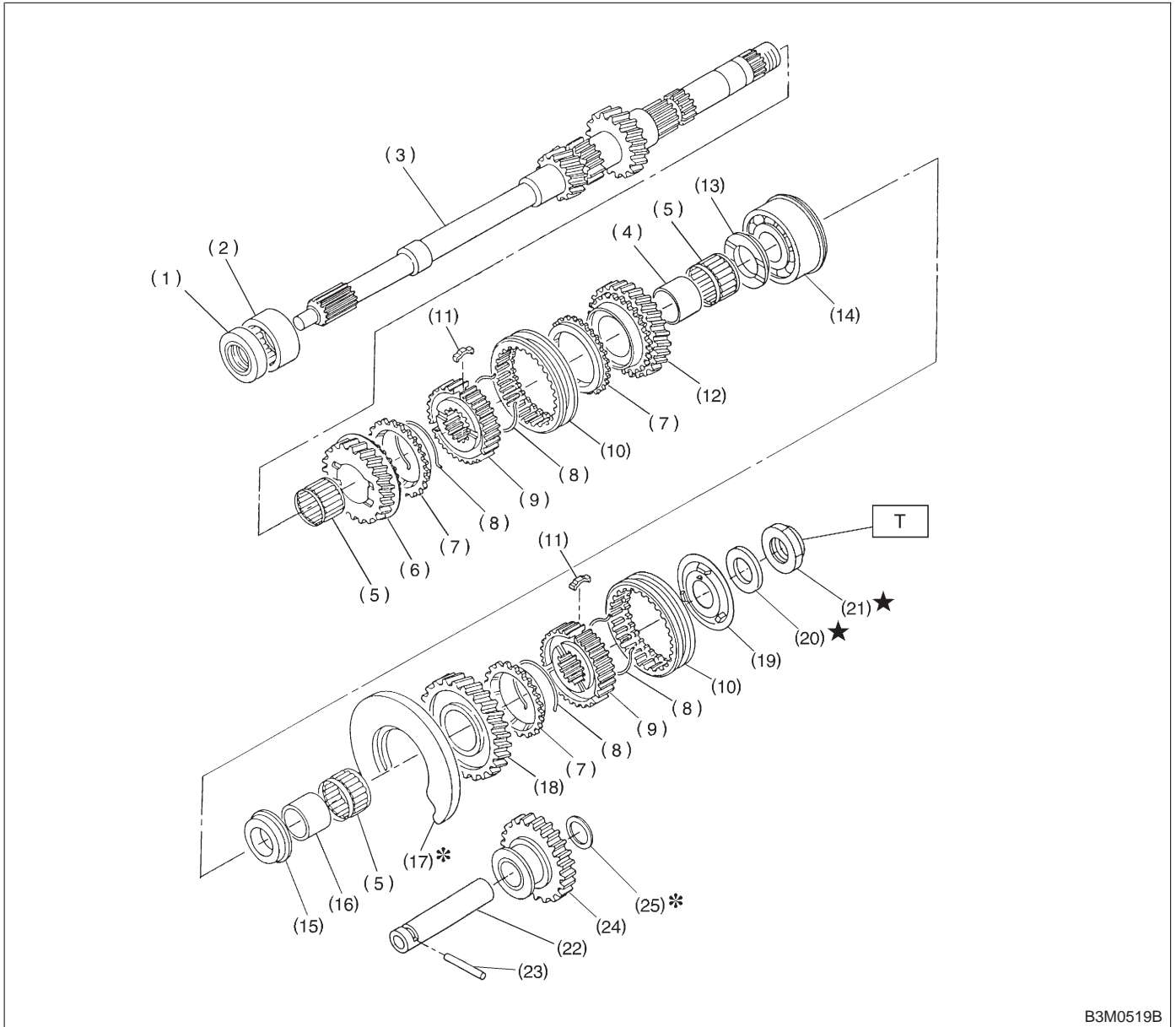

B3M0519B

- | | | |
|-----------------------------|------------------------------|-------------------------------|
| (1) Oil seal | (11) Shifting insert | (21) Lock nut |
| (2) Needle bearing | (12) 4th drive gear | (22) Reverse idler gear shaft |
| (3) Transmission main shaft | (13) 4th gear thrust washer | (23) Straight pin |
| (4) 4th needle bearing race | (14) Ball bearing | (24) Reverse idler gear |
| (5) Needle bearing | (15) 5th gear thrust washer | (25) Washer |
| (6) 3rd drive gear | (16) 5th needle bearing race | |
| (7) Baulk ring | (17) Main shaft rear plate | |
| (8) Synchronizer spring | (18) 5th drive gear | |
| (9) Synchronizer hub | (19) Insert stopper plate | |
| (10) Coupling sleeve | (20) Lock washer | |

Tightening torque: N-m (kg-m, ft-lb)
T: 118±6 (12.0±0.6, 86.8±4.3)

COMPONENT PARTS

[C3B0] 3-1
3. Main Shaft Assembly

B: 2500 cc MODEL

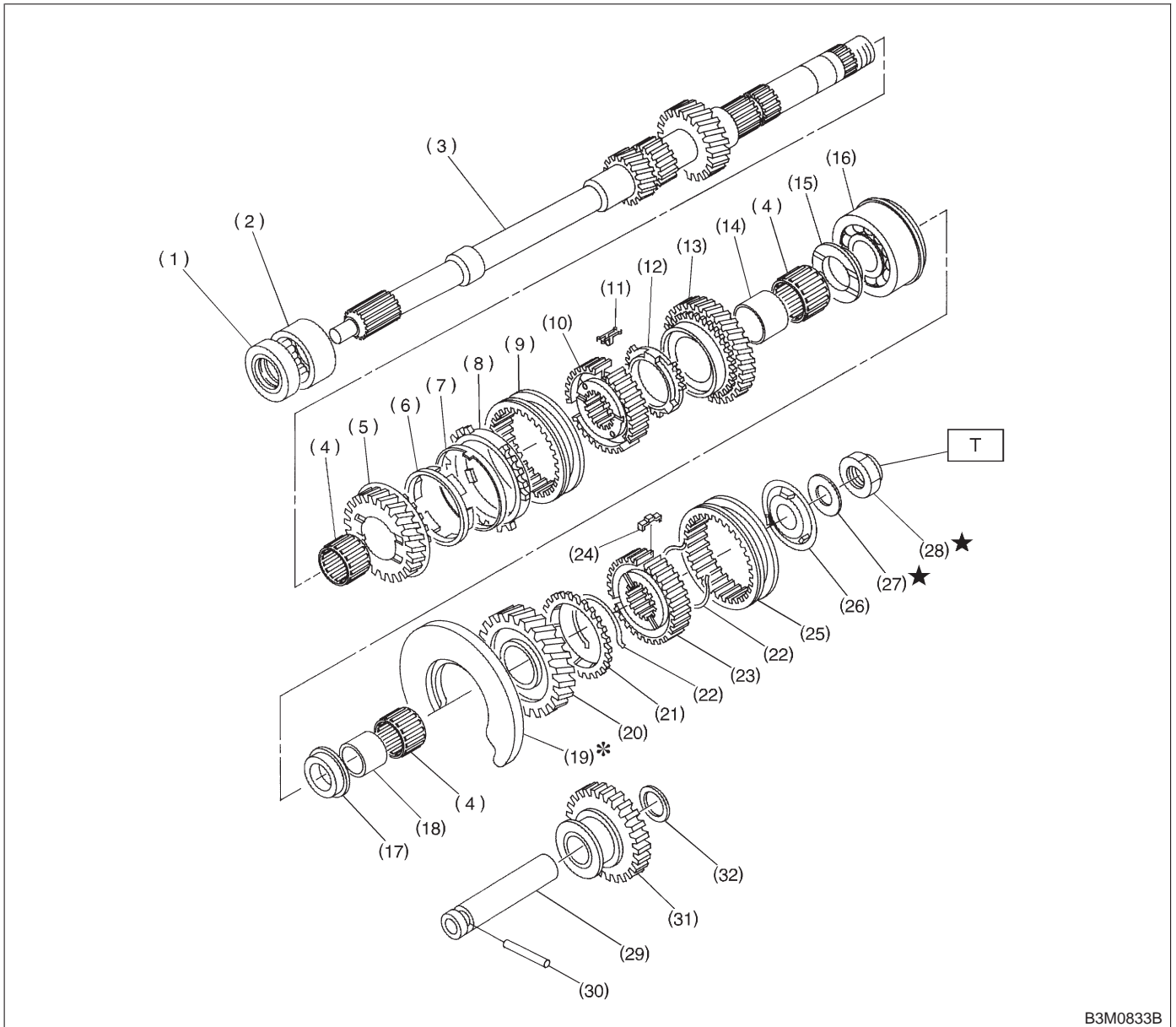

B3M0833B

- | | | |
|-----------------------------|------------------------------|-------------------------------|
| (1) Oil seal | (13) 4th drive gear | (25) Coupling sleeve |
| (2) Needle bearing | (14) 4th needle bearing race | (26) Insert stopper plate |
| (3) Transmission main shaft | (15) 4th gear thrust washer | (27) Lock washer |
| (4) Needle bearing | (16) Ball bearing | (28) Lock nut |
| (5) 3rd drive gear | (17) 5th gear thrust washer | (29) Reverse idler gear shaft |
| (6) Inner baulk ring | (18) 5th needle bearing race | (30) Straight pin |
| (7) Synchro cone | (19)* Main shaft rear plate | (31) Reverse idler gear |
| (8) Outer baulk ring | (20) 5th drive gear | (32) Washer |
| (9) Coupling sleeve | (21) 5th baulk ring | |
| (10) Synchronizer hub | (22) Synchronizer spring | |
| (11) Insert key | (23) Synchronizer hub | |
| (12) 4th baulk ring | (24) Shifting insert | |

Tightening torque: N-m (kg-m, ft-lb)
T: 118±6 (12.0±0.6, 86.8±4.3)