

5. Transfer Case and Extension

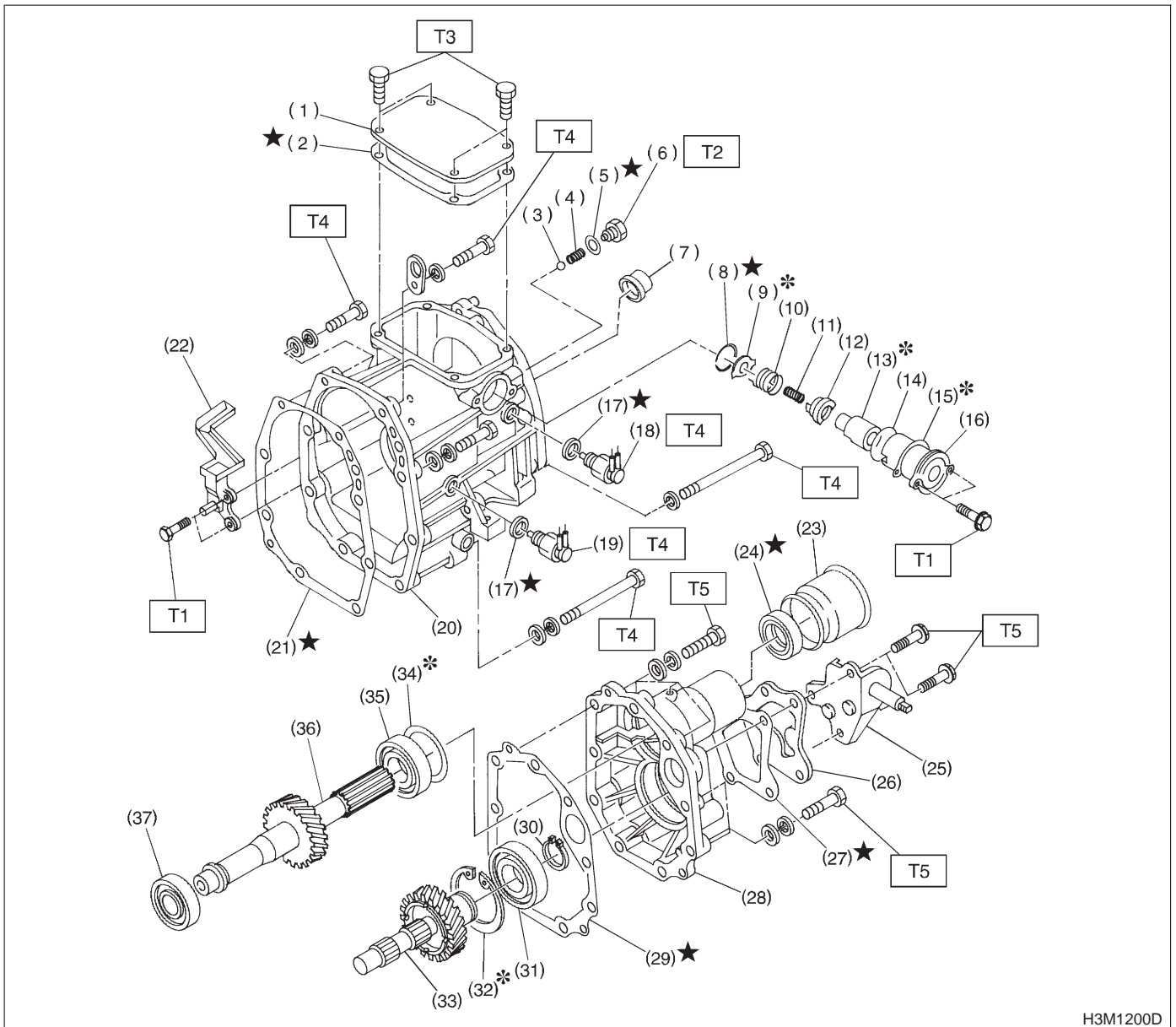

H3M1200D

- | | | |
|----------------------------|---------------------------|---------------------------|
| (1) Transfer cover | (16) Reverse check sleeve | (31) Ball bearing |
| (2) Cover gasket | (17) Gasket | (32) Snap ring (Inner-72) |
| (3) Ball | (18) Neutral switch | (33) Transfer drive gear |
| (4) Reverse accent spring | (19) Back-up light switch | (34) Adjusting washer |
| (5) Gasket | (20) Transfer case | (35) Ball bearing |
| (6) Plug | (21) Gasket | (36) Transfer driven gear |
| (7) Oil seal | (22) Oil guide | (37) Ball bearing |
| (8) Snap ring (Inner) | (23) Dust cover | |
| (9) Reverse check plate | (24) Oil seal | |
| (10) Reverse check spring | (25) Shift bracket | |
| (11) Reverse return spring | (26) Extension cover | |
| (12) Reverse check cam | (27) Gasket | |
| (13) Reverse accent shaft | (28) Extension | |
| (14) O-ring | (29) Gasket | |
| (15) Adjusting select shim | (30) Snap ring (Outer-30) | |

Tightening torque: N-m (kg-m, ft-lb)

T1: 5±1 (0.5±0.1, 3.6±0.7)

T2: 10±1 (1.0±0.1, 7.2±0.7)

T3: 15.7±1.5 (1.6±0.15, 11.6±1.1)

T4: 25±2 (2.5±0.2, 18.1±1.4)

T5: 37±3 (3.8±0.3, 27.5±2.2)