

4. Cylinder Block

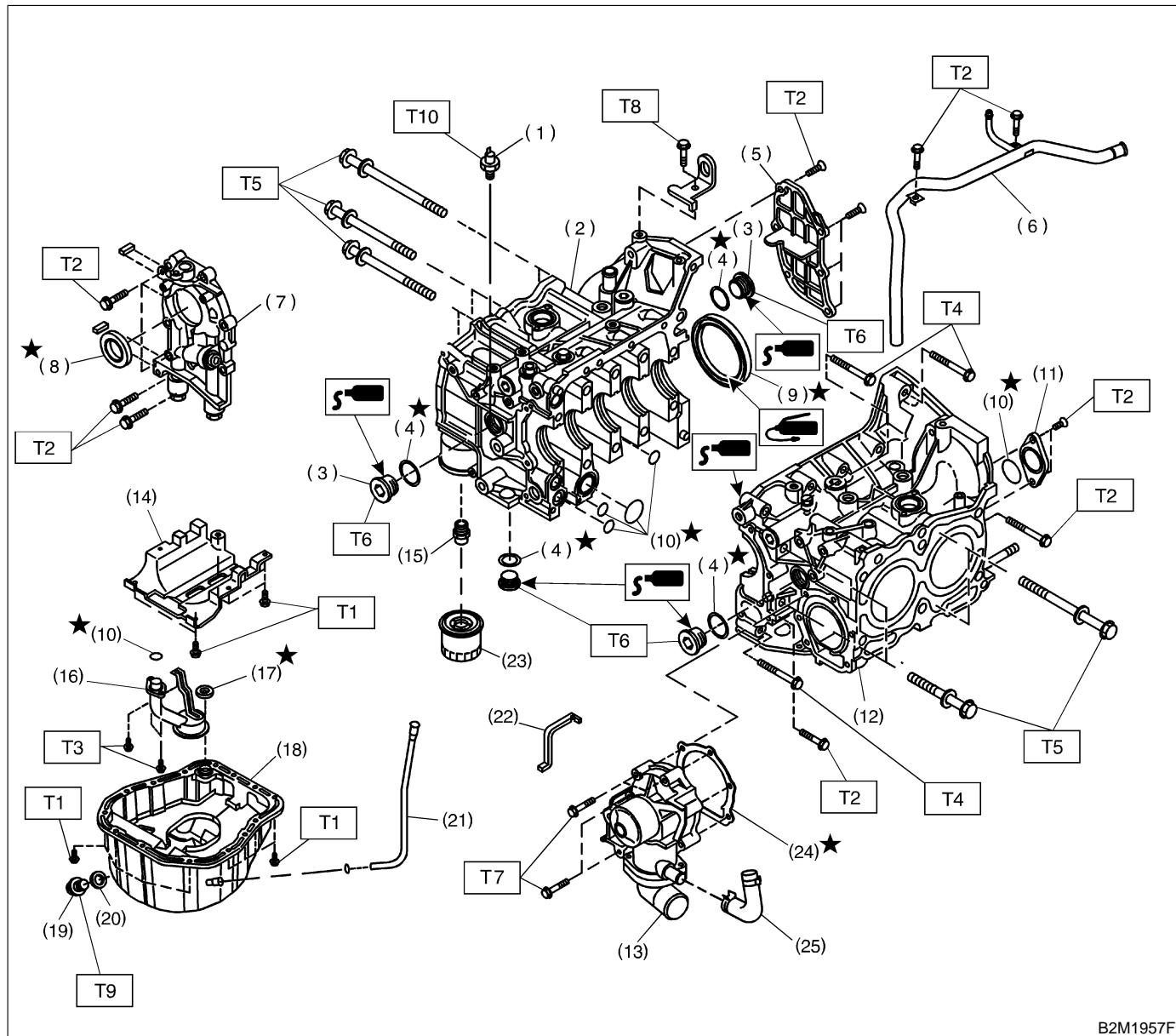

- (1) Oil pressure switch
- (2) Cylinder block (RH)
- (3) Service hole plug
- (4) Gasket
- (5) Oil separator cover
- (6) Water by-pass pipe
- (7) Oil pump
- (8) Front oil seal
- (9) Rear oil seal
- (10) O-ring
- (11) Service hole cover
- (12) Cylinder block (LH)
- (13) Water pump
- (14) Baffle plate
- (15) Oil filter connector
- (16) Oil strainer
- (17) Gasket
- (18) Oil pan
- (19) Drain plug
- (20) Metal gasket
- (21) Oil level gauge guide
- (22) Water pump sealing
- (23) Oil filter
- (24) Gasket
- (25) Water pump hose

**Tightening torque: N-m (kg-m, ft-lb)**

- T1: 5 (0.5, 3.6)**
- T2: 6.4 (0.65, 4.7)**
- T3: 10 (1.0, 7)**
- T4: 25±2 (2.5±0.2, 18.1±1.4)**
- T5: 47±3 (4.8±0.3, 34.7±2.2)**
- T6: 69±7 (7.0±0.7, 50.6±5.1)**
- T7: First 12±2 (1.2±0.2, 8.7±1.4)**  
**Second 12±2 (1.2±0.2, 8.7±1.4)**
- T8: 16±1.5 (1.6±0.15, 11.6±1.1)**
- T9: 44 (4.5, 33)**
- T10: 25±3 (2.5±0.3, 18.1±2.2)**