

3. Blower Motor Assembly

A: REMOVAL AND INSTALLATION

- 1) Disconnect GND cable from battery.
- 2) Remove stopper (A) and then remove glove box.

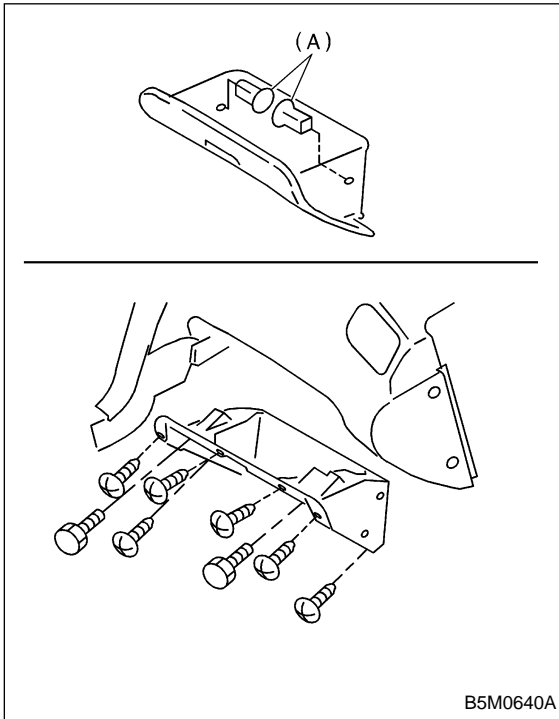

- 3) Disconnect blower motor harness connector.
- 4) Disconnect aspirator pipe (A).
- 5) Remove blower motor mounting screw.

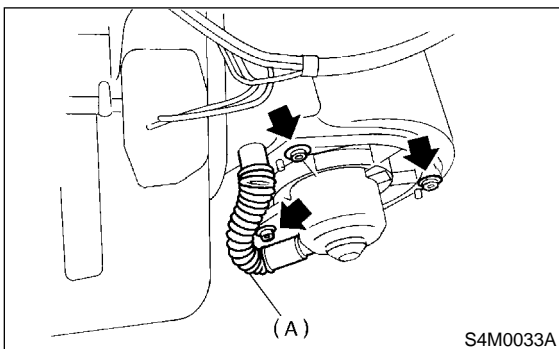

- 6) Remove blower motor assembly.
- 7) Installation is in the reverse order of removal.

4. Control Unit

A: REMOVAL AND INSTALLATION

- 1) Disconnect GND cable from battery.
- 2) Remove console box. <Ref. to 5-4 [W1A0].>
- 3) Set temperature control switch (A) to "FULL HOT" and then disconnect temperature control cable from bottom of heater unit.

NOTE:

Do not attempt to move switch and link during installation.

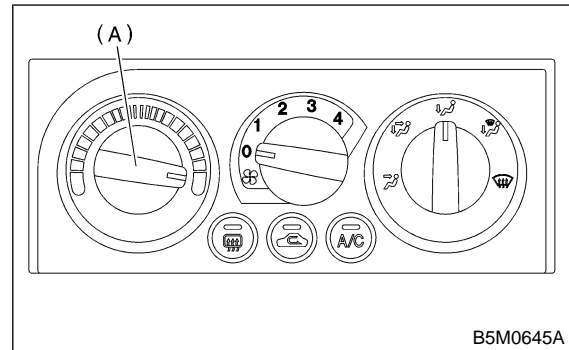

- 4) Remove front cover (A) while disconnecting connector.
- 5) Remove two screws (B) and then remove center panel (C) while disconnecting connector.

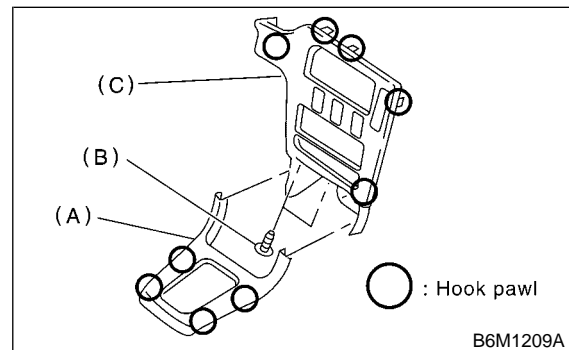

- 6) Remove fitting screws, and slightly pull radio bracket out from center console while disconnecting connector.

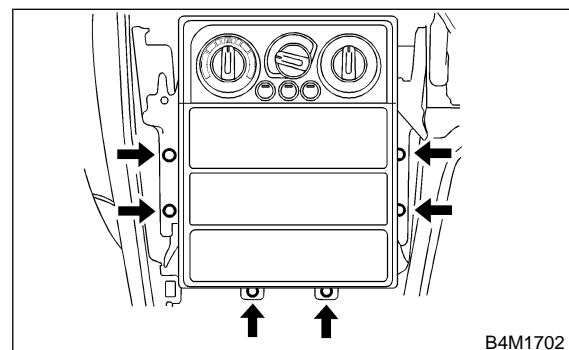

7) Disassemble radio bracket.

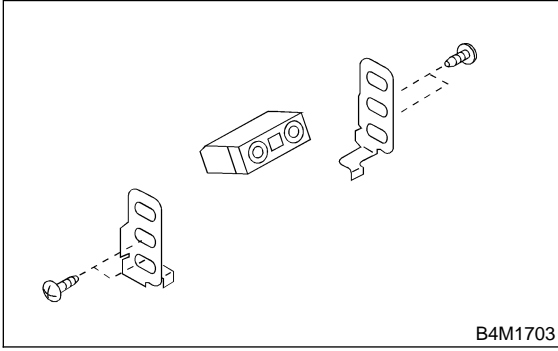

B4M1703

8) Installation is in the reverse order of removal.

NOTE:

Before installing control unit, set temperature control switch to "FULL HOT" position.

B: INSPECTION

1. FAN SWITCH

Check continuity between terminals at each switch position.

Switch position	Terminals					
	4	5	6	3	1	2
OFF						
1				○	○	○
2			○		○	○
3		○			○	○
4	○				○	○



B4M2243

2. MODE ACTUATOR SWITCH

Check continuity between terminals at each switch position.

Switch position	Terminals					
	1	13	3	12	2	11
OFF		○	○	○	○	○
+	●	●	○	○	○	○
+	●	●	●	○	○	○
+	●	●	●	●	○	○
+	●	●	●	●	●	

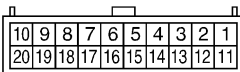

B4M2244

3. FRESH/RECIRC SWITCH

Check continuity between terminals at each switch position.

Switch position	Terminals			
	6	7	8	10
Fresh	●			●
		○	○	
Recirc	○		○	
		●		●

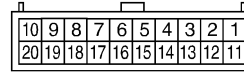

B4M2245